

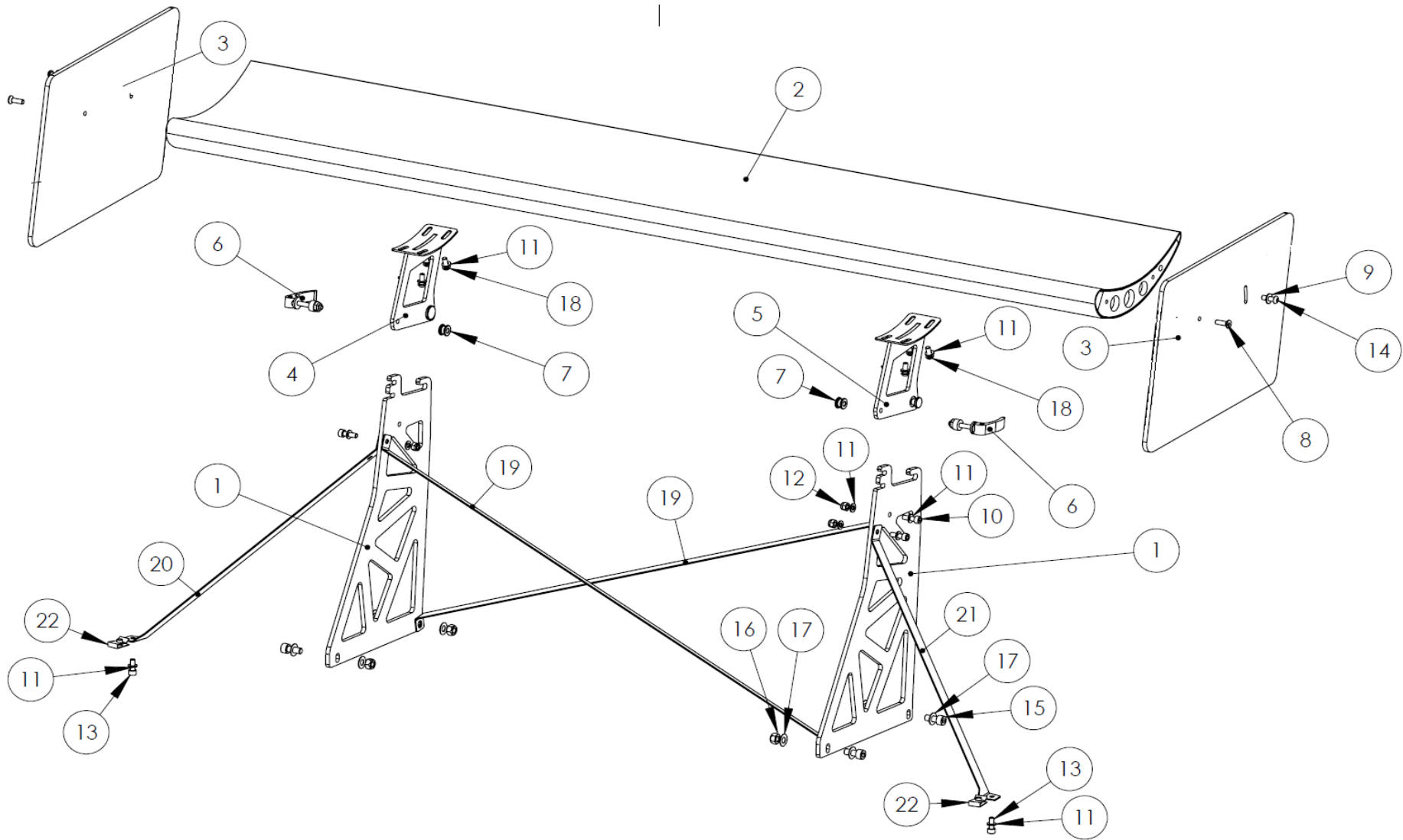

AILERON



TARIFS HT

| N° | REF | DESCRIPTION | DESCRIPTION | QTE |
|----|-------|--------------------------------|-----------------------------------|-----|
| 1 | CC220 | MAT AILERON INF | LOWER WING SUPPORT STRUCTURE | 2 |
| 2 | CC221 | AILERON MITJET 2L | REAR WING MITJET 2L | 1 |
| 3 | CC222 | DERIVE AILERON | REAR WING END PLATES | 2 |
| 4 | CC223 | MAT AILERON SUP D | UPPER RIGHT WING SUPPORT | 1 |
| 5 | CC224 | MAT AILERON SUP G | UPPER LEFT WING SUPPORT | 1 |
| 6 | CC225 | COLLIER DE SERRAGE MAT AILERON | WING LOCKING CLAMP | 2 |
| 7 | CC226 | BOBINE MAT AILERON | WING LOCKING CLAMP BOBIN | 2 |
| 8 | CC227 | VIS FHC M6x20 CL10.9 | SCREW FHC M6X20 CL10.9 | 2 |
| 9 | CC228 | RONDELLE D6 D14 PLATE | WASHER D6 D14 | 2 |
| 10 | CC229 | VIS CHC M6x20 CL 12.9 | CAP HEAD SCREW CHC M6X20 CL12.9 | 3 |
| 11 | CC230 | RONDELLE D6 D12 CONTACT | WASHER D6 D12 | 16 |
| 12 | CC245 | ECROU M6 NYLSTOP ZINGUE | ZINC NYLOCK NUT M6 | 3 |
| 13 | TR221 | VIS CHC M6x16 CL8.8 | CAP HEAD SCREW CHC M6X16 CL8.8 | 2 |
| 14 | CC233 | VIS BHC M6x20 ZN | TRUSS HEAD SCREW BHC M6X20 ZN | 2 |
| 15 | CC234 | VIS CHC M8X20 CL8.8 ZN | CAP HEAD SCREW CHC M8X20 CL8.8 ZN | 4 |
| 16 | CH236 | ECROU M8 NYLSTOP BICHROMATE | BICHROME NYLOCK NUT M8 | 4 |
| 17 | EQ228 | RONDELLE D8 ONDULEE | ANTI VIBRATION WASHER D8 | 4 |
| 18 | CC248 | VIS BHC M6x15 | TRUSS HEAD SCREW BHC M6X15 | 8 |
| 19 | CC238 | TIRANT INTER RENFORT MAT AILER | CENTRAL WING SUPPORT STRUT | 1 |
| 20 | CC239 | TIRANT DROIT AILERON PC AR | RIGHT HAND WING SUPPORT TIE BAR | 1 |
| 21 | CC240 | TIRANT GAUCHE AILERON PC AR | LEFT HAND WING SUPPORT TIE BAR | 1 |
| 22 | TR06 | CLIPS ECROU M6 24x16 | CAPTIVE NUT M6 25X16 | 2 |